

+KEYIN

# PRODUCT MANUAL

KeyinE



Product design and functions can be changed without notice to improve quality or performance.

# 01 Component Check

---

Main Body  
(Indoor)

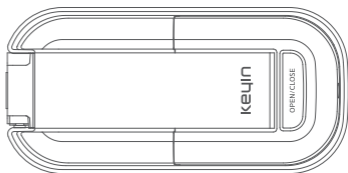

Main Bracket

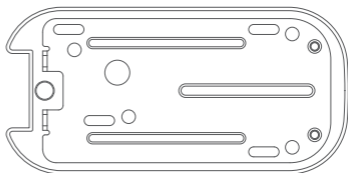

Strike



3 Batteries

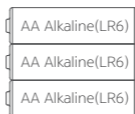

Easy Manual	Install Manual
Installation Screws	

## 02 Name of parts

---

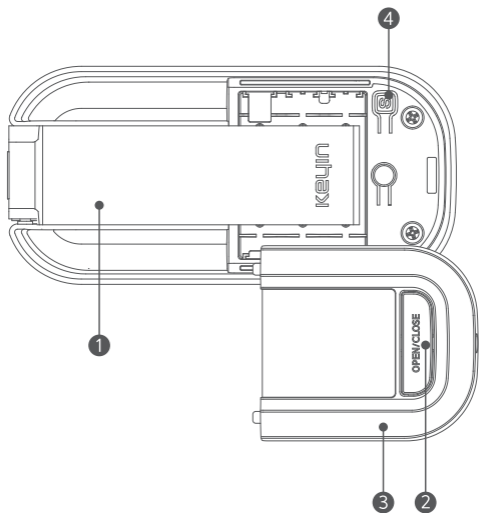

1	Door Chain	2	OPEN/CLOSE Button
3	Battery Cover	4	Registration Button

# 03 Preparations \_\_\_\_\_

## 01. Opening battery cover

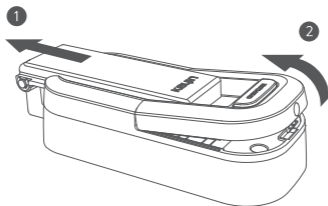

After pushing the end of the product with your finger, lift the cover while pressing the end of the battery cover

## 02. Closing battery cover

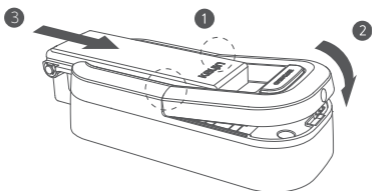

After inserting the end of the battery cover into the body first, Move to the door chain to its original position.

# 04 Registering & Deleting in the App

## 01. Registering & Deleting KeyinE in the app

Registration

Press the **(S)** button (inside of the door lock) and register according to the instructions in the app.

## 02. Connecting KeyinE to Keyin Doorlock

### Connecting in the App

After registering the KeyinE in the app, you can link it by using the Keyin App

### Connecting manually without the app

KeyinE can be manually connected to the door lock without the app. After installation, you can connect KeyinE to the doorlocks by using the touch pad

---

Connecting      Password >  > 51 >  > 2 > 

---

Disconnecting      Password >  > 53 >  > 2 > 

---

# 05 Unlocking

---

## 01. Unlocking by open/close button

Press the open/close button to unlock / lock the device.

## 02. Unlocking by the app

Please run the app, then touch the screen to unlock the device

※ It requires to set the feature to lock the device in the app  
(Basically the locking feature is not set)

## 03. Unlocking manually (in case of emergency)

You can unlock or lock the device by pushing the end of the door chain

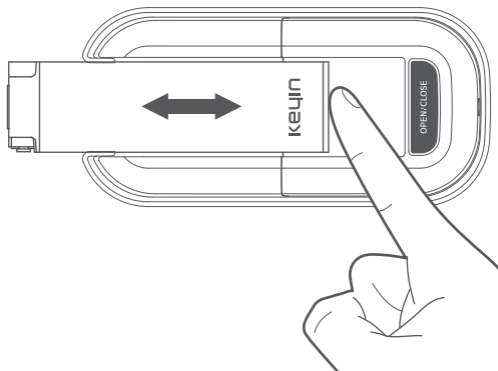

# 06 Setting

---

## 01. Volume Control Setup

You can setup the volume up to 7 levels(0~6) in the app

## 02. Sync locking mode setting/unset

Sync locking is a function that automatically locks the Keyin E after the door lock is locked.

Setting	Press the open/close button for 5 seconds without setting the lock function
Unset	Press the open/close button for 5 seconds with the lock function set

※ Sync locking is available only when linking with Keyin door lock, When the battery is out, the device is automatically unlocked, but depending on the installation environment, unlocking may not be possible, so it is recommended to use it when there is someone who can unlock the device manually in home.

## 03. Safe Open Mode

If you press the safety open button on the inside of the door lock, KeyinE is locked and only the door lock is unlocked to check who has come. The function is activated when connecting with keyin's door lock without any setting.

※ The feature is enabled when connecting with keyin's door lock, It's not been enabled on the door lock without safe open button.

# 07 Alarms

---

## 01. Low battery alarm

When it's time to change batteries, the device sets out a melody to inform users. When you hear the alarm, please change the batteries as soon as possible. Original 1.5V Alkaline batteries with AA(LR6) size must be used. The device operates about a year with these batteries when used 3 times a day.

Take precaution, because batteries can leak when inserted in wrong direction. When exchanging the batteries, exchange all remaining batteries even if they are still working. Mixing new batteries with old ones can also cause leakage.

- ※ When the battery replacement melody sounds, KeyinE automatically unlocks and it doesn't work. It can be manually unlocked or locked in case of emergency

## 02. Fire Alert

In case of fire, the device detects high temperature, sets out an alarm, and unlocks the device automatically to help escape.

- ※ All alarms is disabled by pressing the open/close button for 5 seconds

# 08 Specifications and Precautions

---

## 01. Product Spec

Size & Spec	Main Body (Indoor)	151(W)X74(H)X43(D)mm
	Battery	AA Alkaline(LR6) Batteries x 3 1 year usage with 3 operations a day

\* Battery lasting time may vary depending on battery lifetime.

## 02. Safety Precautions

- Installation in open environment with rain exposure, direct sunray, or too humid and salty places (beaches) is not recommended
- Disassembling the device can cause malfunction and can be dangerous
- Maintain the device clean. Do not spray water directly. Do not use chemical substances like benzene and alcohol to clean the device.
- Do not apply excessive shock to the device.
- Check if the door is properly closed when leaving.
- Getting hit by door chain can cause injury.
- Using in places with severe condensation can cause problems to the device.

+KEYIN